

PILLAR SURFACE

INSTALLATION INSTRUCTIONS
WITH CEILING PLATE

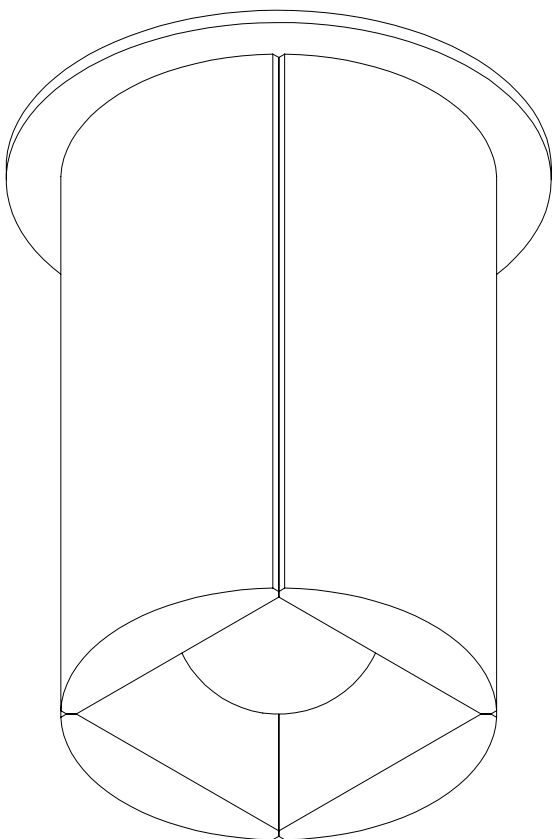

E12 BULB

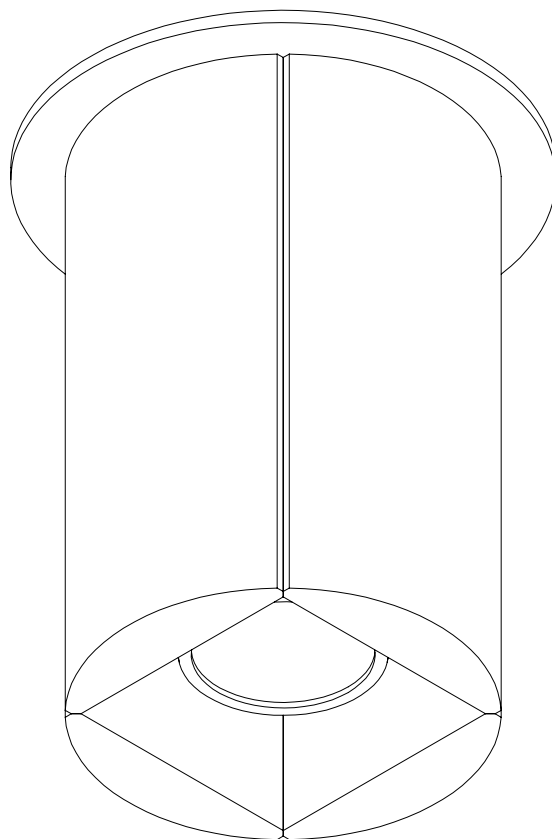

MR16 BULB

INSTALLATION OVERVIEW

PARTS + NOTES

- | | | |
|---------------|-------------------------------|----------------------|
| A. Fixture | C. E12 bulb or MR16 GU10 bulb | E. Mounting Screw x2 |
| B. Wall Plate | D. Wire Nut x3 | F. 3/32" Hex Key |

CAUTION

Make sure building power is disconnected prior to handling wires. Installation should be done by a certified electrician.

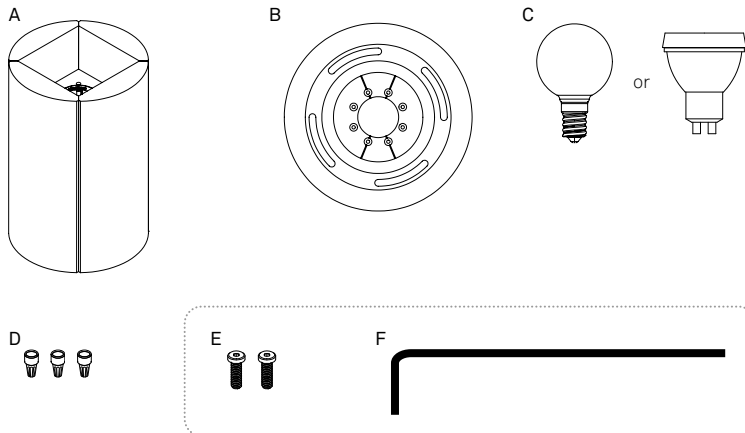
**NOTE:**

This installation option requires an octagonal J-box. For installation without a wall plate see [Surface without Wall Plate Installation Instructions](#).

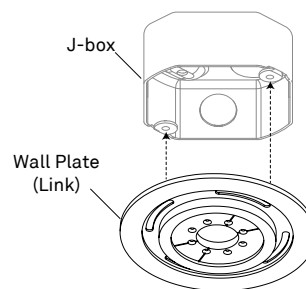

FIXTURE INSTALLATION

1

Mounting

Attach wall plate (B) to j-box using mounting screws (E) and hex key (F).

2

Connect Wires

Connect white, black and green wires using wire nuts (D). Cap any extra wires in the j-box and tuck all wires through the central hole in wall plate (B). (Note: support fixture while connecting wires)

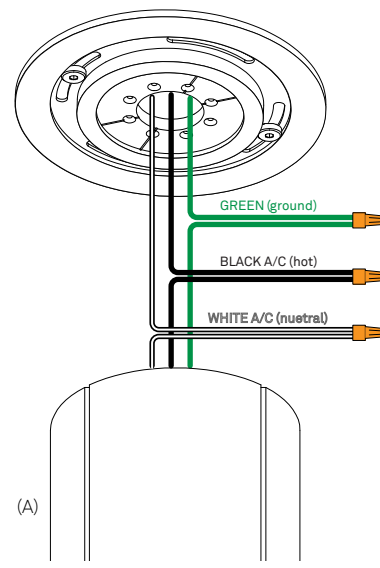
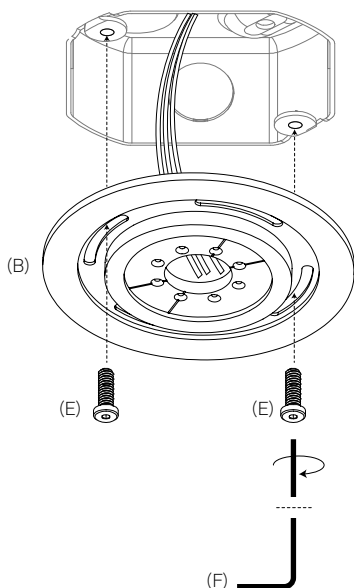

CAUTION

Make sure building power is disconnected prior to handling wires. Installation should be done by a certified electrician.

FIXTURE INSTALLATION

3 Secure Fixture

Carefully insert hex key (F) into small holes near bulb socket so as not to scratch metal surface of fixture. Push the invisible screw inside the fixture into alignment with the holes in the wall plate and tighten until fixture is firmly pressed against the plate.

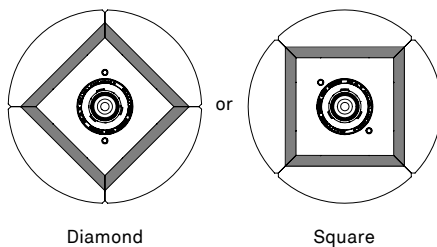
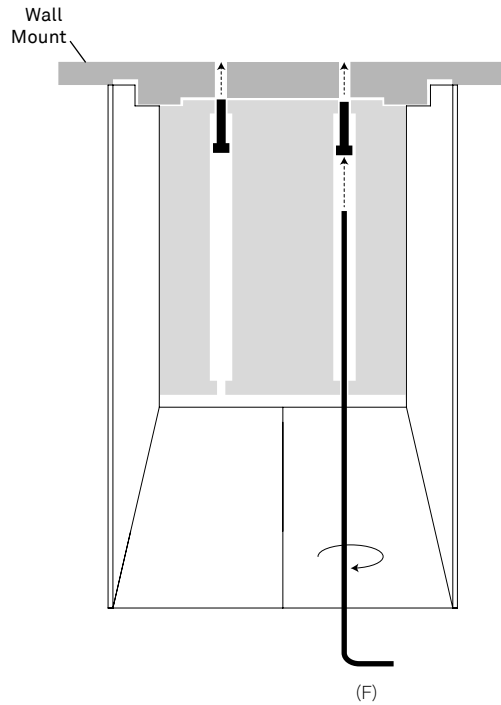
**4 Install Bulb**

Screw in E12 OR MR16 Bulb (C) provided with fixture.

